

SPINNING REEL G1350T/1650T

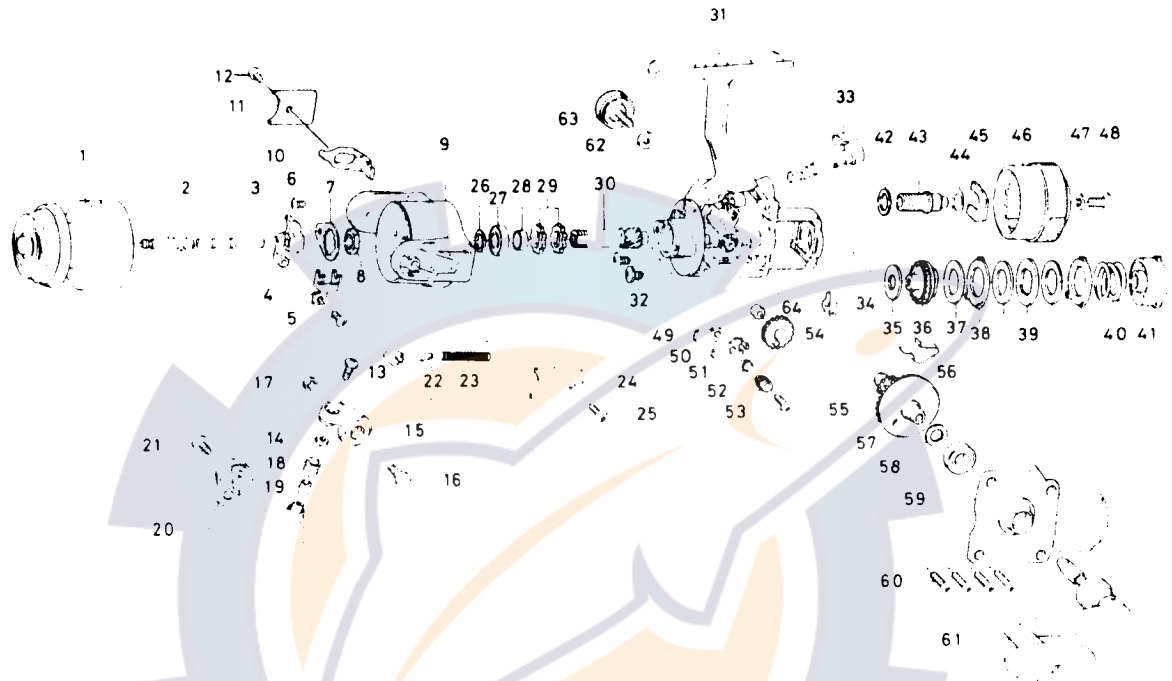

| Key No. | Parts No. | Parts Name | Key No. | Parts No. | Parts Name |
|---------|-----------|-------------------------------|---------|-----------|----------------------------|
| 1 | E28 8401 | Spool assembly | 37 | F21 5001 | Drag washer B |
| 2 | E23 0801 | Main shaft assembly | 38 | E21 5101 | Eared washer |
| 3 | K11 1601 | Oscillating slider | 39 | E21 5201 | Key washer |
| 4 | K11 1701 | Oscillating slider retainer | 40 | K10 9701 | Drag coil spring |
| 5 | 351 0903 | Oscillating slider screw | 41 | E27 0801 | Drag nut |
| 6 | B83 4402 | Rotor nut holding plate screw | 42 | E21 5401 | Drag screw washer A |
| 7 | K11 1201 | Rotor nut holding plate | 43 | E28 7701 | Drag screw |
| 8 | B10 5701 | Rotor nut | 44 | 373 7810 | Drag screw washer B |
| 9 | E23 5801 | Rotor | 45 | E21 5702 | Drag screw retainer |
| 10 | K11 1001 | Bail trip lever | 46 | E22 8401 | Drag knob |
| 11 | E20 2401 | Bail trip cover | 47 | 375 1001 | Drag knob washer |
| 12 | B83 4401 | Bail trip cover screw | 48 | 353 8203 | Drag knob screw |
| 13 | B67 9302 | Line roller screw | 49 | K10 8801 | Anti reverse pawl plate |
| 14 | B55 4301 | Line roller washer | 50 | K10 9101 | Anti reverse pawl |
| 15 | K11 0401 | Bail arm | 51 | K10 9201 | Anti reverse pawl spring A |
| 16 | K11 2601 | Bail arm screw | 52 | B96 5501 | Anti reverse pawl collar |
| 17 | 320 5901 | Bail arm screw retainer | 53 | B00 9701 | Anti reverse pawl screw |
| 18 | 250 3921 | Line roller | 54 | B74 2503 | Oscillating gear |
| 19 | B45 1501 | Line roller bushing | 55 | E28 7801 | Drive gear |
| 20 | K11 0701 | Bail assembly | 56 | K11 1301 | Anti reverse pawl spring B |
| 21 | B84 2101 | Bail trip cam screw | 57 | 373 7800 | Drive gear washer |
| 22 | E21 3501 | Bail spring shaft | 58 | E15 4001 | Ball bearing B |
| 23 | K11 0301 | Bail spring | 59 | E22 8901 | Side cover |
| 24 | K11 0501 | Bail spring cover | 60 | B83 5001 | Side cover screw |
| 25 | B83 4401 | Bail spring cover screw | 61 | E23 4701 | Handle assembly |
| 26 | 371 2827 | Ball bearing retaining washer | 62 | B92 4902 | Handle lock washer |
| 27 | B54 6001 | Ball bearing A | 63 | B92 5001 | Handle lock screw |
| 28 | K11 1101 | Spacing sleeve | 64 | E29 9401 | Oscillating gear collar |
| 29 | K10 9501 | Anti reverse ratchet | | | |
| 30 | K10 9301 | Pinion gear | | | |
| 31 | E22 8103 | Body | | | |
| 32 | B84 2102 | Bearing retainer screw | | | |
| 33 | E23 0701 | Anti reverse lever | | | |
| 34 | B58 8601 | Anti reverse cam spring | | | |
| 35 | E21 4801 | Drag washer A | | | |
| 36 | K10 9601 | Click gear | | | |

| G1650T Special Parts | | |
|----------------------|----------|-----------------|
| 1 | E28 8601 | Spool assembly |
| 9 | E23 6001 | Rotor |
| 20 | K11 3001 | Bail assembly |
| 31 | E22 8104 | Body |
| 61 | E23 1101 | Handle assembly |